

L形側溝 (JIS A5372)

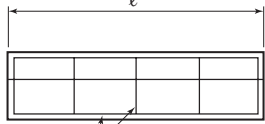

すり付け用左

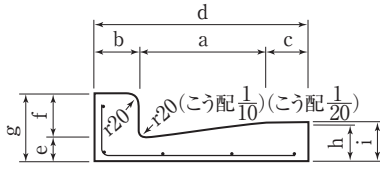
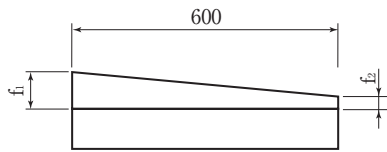

すり付け用右

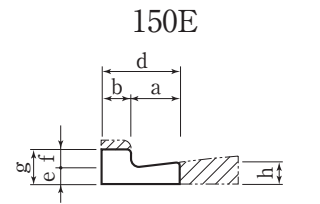
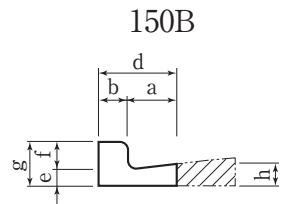
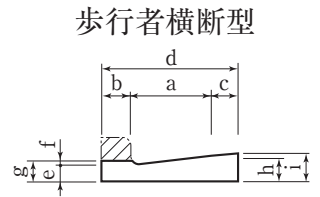
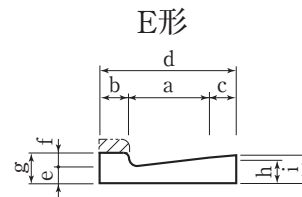
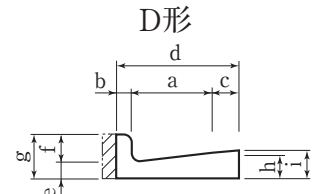
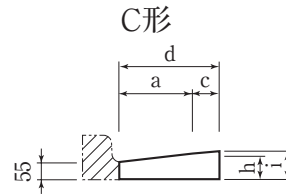
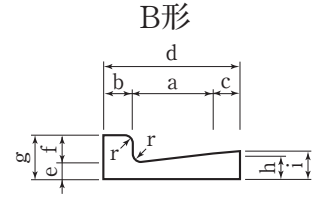
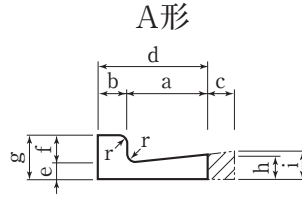
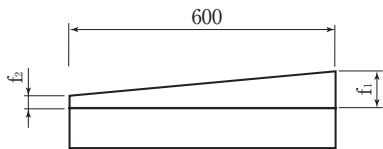

呼 び	すり付け部	f ₁	f ₂
斜 ⁵ / ₁₀ (左・右)	B形↔E形	100	50
斜 ² / ₁₀ (左・右)	B形↔歩行者形	100	20
斜 ² / ₅ (左・右)	E形↔歩行者形	50	20

仕様寸法表(単位^{mm})

呼 び	寸 法										鉄 筋				重量 (kg)	
	a	b	c	d	e	f	g	h	i	ℓ	縦鉄筋		横鉄筋			
											径	数量 (本)	径	数量 (本)		
道路用鉄筋 コンクリートL形	250A	250	100	—	350	55	100	155	80	—	600	4	4	4	5	45
	250B	250	100	100	450	55	100	155	80	85	600	4	5	4	5	57
	250C※	230	—	100	330	55	—	—	80	85	600	4	3	4	5	35
	250D※	250	50	100	400	55	100	155	80	85	600	4	5	4	5	46
	250E	250	100	100	450	55	50	105	80	85	600	4	5	4	5	50
	250歩行者※	250	100	100	450	55	20	75	80	85	600	4	5	4	5	47
	300B	300	100	100	500	55	100	155	85	90	600	4	5	4	6	63
	300C※	280	—	100	380	55	—	—	85	90	600	4	3	4	6	41
	300D※	300	50	100	450	55	100	155	85	90	600	4	5	4	6	52
	300E	300	100	100	500	55	50	105	85	90	600	4	5	4	6	56
	300歩行者※	300	100	100	500	55	20	75	85	90	600	4	5	4	6	53
	350B	350	100	100	550	55	100	155	90	95	600	4	5	6	5	70
	350E	350	100	100	550	55	50	105	90	95	600	4	5	6	5	63
	350歩行者※	350	100	100	550	55	20	75	90	95	600	4	5	6	5	60
	150B※	150	100	—	250	55	100	155	70	—	600	4	4	4	5	30
150E※	150	100	—	250	55	50	105	70	—	600	4	4	4	5	23	